

Important steps to follow before the soil evaluation assessment

- 1.** Stake off the four (4) corners of the lot.
- 2.** Stake off the four (4) corners where the house will be located.
- 3.** Post the orange card on the lot that will be evaluated so that it is visible from the road.
- 4.** Call the Environmental Specialist once the property has been staked off and they will designate a date and time to conduct the soil evaluation assessment.

For more information, please call Scotland County Health Department at (910) 277-2440!

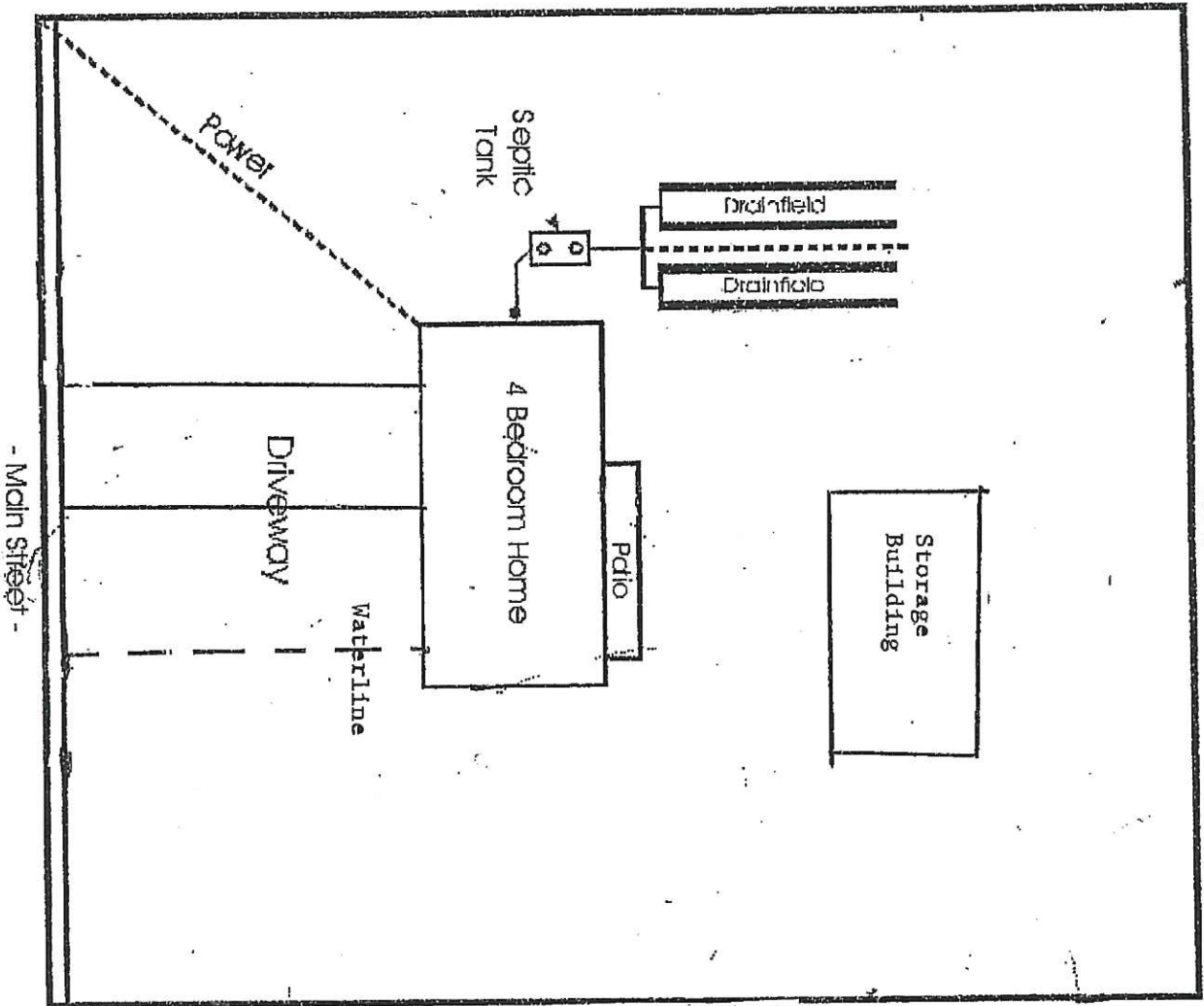

Site Plan Example

- 270 -

The site plan or plat must indicate:
 existing and proposed property lines with dimensions,
 the location of the facility with dimensions and setbacks,
 all appurtenances (driveway, decks, outbuildings, sidewalks, etc.),
 the site for the proposed wastewater system and
 the location of water supplies and surface waters and,
 any existing or proposed easement(s), encroachment agreement, and/or
 right(s) of-way (e.g., access easement, utility easement, road or electrical
 right-of-way, etc.), including use, type, location and dimensions in
 accordance with accompanying copies of legal documentation.